

DISCOVERY HAHNDORF RESORT

Accommodation Sheet

(03) 8388 7921 | hahndorf@discoveryparks.com.au

Cottages

- Sleeps 2
- Open Plan
- 1 Queen bed
- En-suite bathroom with vanity, shower, toilet, hair dryer
- Microwave, toaster, kettle, bar fridge, crockery, cutlery, glasses, sink
- Reverse cycle air conditioning
- All linen provided
- Electric blankets
- Dining table & chairs
- Flat screen TV
- Free Wi-Fi
- Iron & ironing board
- Welcome tea, coffee, sugar, milk, shampoo & soap
- Outdoor setting
- Serviced daily
- Car park

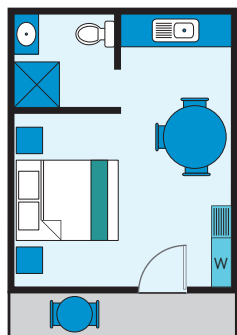

Cottages
Rate: 2 persons
From \$140

Cottages

- Sleeps 3
- Open Plan
- 1 Queen bed & 1 single bed
- En-suite bathroom with vanity, shower, toilet, hair dryer
- Microwave, toaster, kettle, bar fridge, crockery, cutlery, glasses, sink
- Reverse cycle air conditioning
- All linen provided
- Electric blankets
- Dining table & chairs
- Flat screen TV
- Free Wi-Fi
- Iron & ironing board
- Welcome tea, coffee, sugar, milk, shampoo & soap
- Outdoor setting
- Serviced daily
- Car park

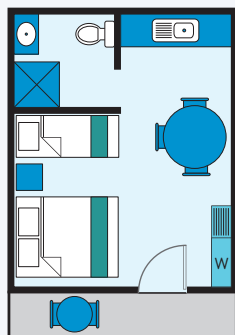

Cottages
Rate: 2 persons
From \$140
Extra Guest (Aged 2 & over) - \$25 each

Resort Rooms

- Sleeps 2 adults (no children allowed)
- Open Plan
- 1 Queen bed
- En-suite bathroom with vanity, shower, toilet, hair dryer
- Kettle, bar fridge, mugs, glasses
- Reverse cycle air conditioning
- All linen provided
- Electric blankets
- Flat screen TV
- Free Wi-Fi
- Iron & ironing board
- Welcome tea, coffee, sugar, milk, shampoo & soap
- Serviced daily
- Car park

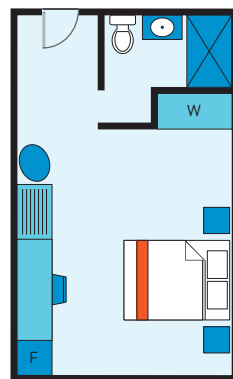

Resort Rooms
Rate: 2 persons
From \$165

Resort Rooms

- Sleeps 2 adults (no children allowed)
- Open Plan
- 2 Queen beds
- En-suite bathroom with vanity, shower, toilet, hair dryer
- Kettle, bar fridge, mugs, glasses
- Reverse cycle air conditioning
- All linen provided
- Electric blankets
- Flat screen TV
- Free Wi-Fi
- Iron & ironing board
- Welcome tea, coffee, sugar, milk, shampoo & soap
- Serviced daily
- Car park

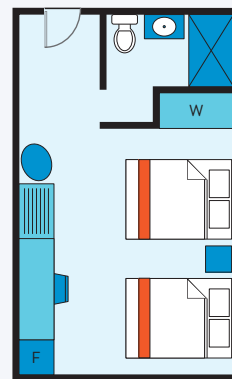

Resort Rooms
Rate: 2 persons
From \$165
Extra Adult - \$25 each

Lakeview Units

- Sleeps 2
- 1 bedroom
- 1 Queen bed
- En-suite bathroom with toilet, shower, vanity, hair dryer (no bath)
- Separate living area with dining table, chairs & couch
- Microwave, toaster, kettle, bar fridge, crockery, cutlery, glasses, sink
- Reverse cycle air conditioning
- All linen provided
- Electric blankets
- Flat screen TV
- Free Wi-Fi
- Iron & ironing board
- Welcome tea, coffee, sugar, milk, shampoo & soap
- Outdoor setting
- Serviced daily
- Car park

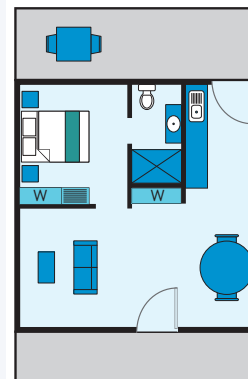

Lakeview Units
Rate: 2 persons
From \$165

2 Bedroom Units

- Sleeps 4
- 2 bedrooms
- 1 Queen bed & 2 singles beds
- Bathroom with vanity, shower, toilet, hair dryer
- Separate living area with dining table, chairs & couch
- Microwave, toaster, kettle, bar fridge, crockery, cutlery, glasses, sink
- Reverse cycle air conditioning
- All linen provided
- Electric blankets
- Flat screen TV
- Free Wi-Fi
- Iron & ironing board
- Welcome tea, coffee, sugar, milk, shampoo & soap
- Outdoor setting
- Serviced daily
- Car park

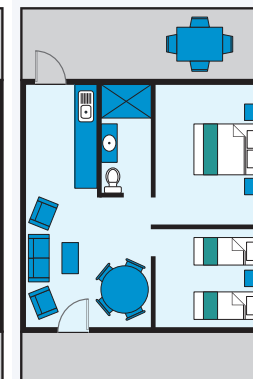

Two Bedroom Units
Rate: 2 persons
From \$165
Extra Guest (Aged 2 & over) - \$25 each

2 Bedroom Units

- Sleeps 4
- 2 bedrooms
- 2 Queen beds
- Bathroom with vanity, shower, toilet, hair dryer
- Separate living area with dining table, chairs & couch
- Microwave, toaster, kettle, bar fridge, crockery, cutlery, glasses, sink
- Reverse cycle air conditioning
- All linen provided
- Electric blankets
- Flat screen TV
- Free Wi-Fi
- Iron & ironing board
- Welcome tea, coffee, sugar, milk, shampoo & soap
- Outdoor setting
- Serviced daily
- Car park

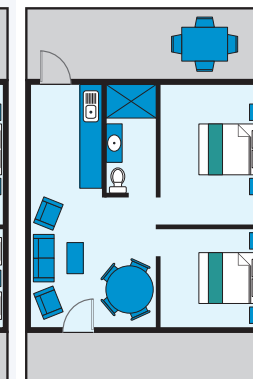

Two Bedroom Units
Rate: 2 persons
From \$165
Extra Guest (Aged 2 & over) - \$25 each

2 Bedroom Spa Units

- Sleeps 4 adults (no children allowed)
- 2 bedrooms
- 2 Queen beds
- Two way bathroom with shower & separate spa, toilet, vanity, hair dryer
- Dining table and chairs & couch in living area
- Microwave, toaster, kettle, bar fridge, crockery, cutlery, glasses, sink
- Reverse cycle air conditioning
- All linen provided
- Electric blankets
- Flat screen TV
- Free Wi-Fi
- Iron & ironing board
- Welcome tea, coffee, sugar, milk, shampoo & soap
- Outdoor setting
- Serviced daily
- Car park

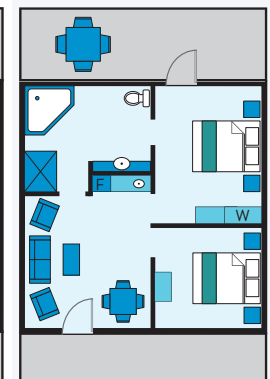

2 Bedroom Spa Units
Rate: 2 persons
From \$190
Extra Adult - \$25 each

Limited Mobility Unit

- Sleeps 2
- 1 bedroom
- Self-contained
- 1 Queen bed
- En-suite bathroom with vanity, shower, toilet, hair dryer
- Cooktop, oven, dishwasher, microwave, toaster, kettle, bar fridge, crockery, cutlery, glasses, sink
- Reverse cycle air conditioning
- All linen provided
- Electric blankets
- Dining table and chairs
- Flat screen TV
- Free Wi-Fi
- Iron & ironing board
- Welcome tea, coffee, sugar, milk shampoo & soap
- Outdoor setting
- Serviced daily
- Car park

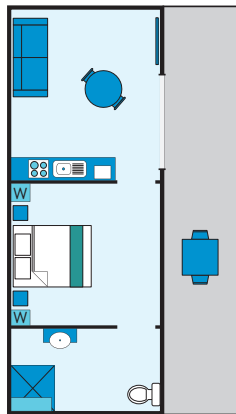

Limited Mobility Unit

Rate: 2 persons
From \$175

Limited Mobility Unit

- Sleeps 4
- 2 bedrooms
- Self-contained
- 2 Queen beds
- En-suite bathroom with vanity, shower, toilet, hair dryer
- Cooktop, oven, dishwasher, microwave, toaster, kettle, bar fridge, crockery, cutlery, glasses, sink
- Reverse cycle air conditioning
- All linen provided
- Electric blankets
- Dining table & chairs
- Flat screen TV
- Free Wi-Fi
- Iron & ironing board
- Welcome tea, coffee, sugar, milk, shampoo & soap
- Outdoor setting
- Serviced daily
- Car park

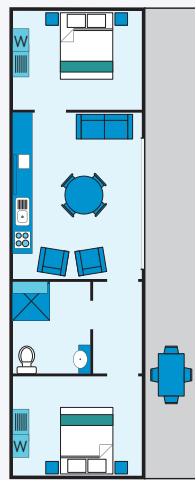

Limited Mobility Unit

Rate: 2 persons
From \$175
Extra Guest (Aged 2 & over)
- \$25 each

Family Cottage

- Sleeps 6
- 2 bedrooms
- 1 Queen bed, 2 singles & 1 set of bunk beds
- En-suite bathroom with vanity, shower, toilet, hair dryer
- Cooktop, microwave, toaster, kettle, large fridge, crockery, cutlery, glasses, sink
- Reverse cycle air conditioning
- All linen provided
- Electric blankets (excluding bunks)
- Flat screen TV
- Free Wi-Fi
- Iron & ironing board
- Welcome tea, coffee, sugar, milk, shampoo & soap
- Outdoor setting
- Serviced daily
- Car park

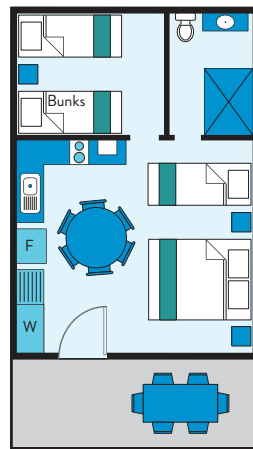

Family Cottage

Rate: 2 persons
From \$165
Extra Guest (Aged 2 & over)
- \$25 each

Lakeview Family Cottages

Minimum 2 night stay

- Sleeps 6
- 2 bedrooms
- Self-contained
- 1 Queen bed & 2 sets of bunk beds
- 1 Bathroom with shower, vanity, hair dryer
- Separate living area with dining table, chairs and lounges
- Full kitchen facilities – dishwasher, oven, cooktop, microwave, kettle, fridge, crockery, cutlery, glasses, sink
- Reverse cycle air conditioning
- All linen provided
- Electric blankets (excluding bunks)
- Flat screen TV
- Iron and Ironing Board
- Welcome tea, coffee, sugar, milk, shampoo & soap
- Outdoor setting
- Serviced daily
- Car park

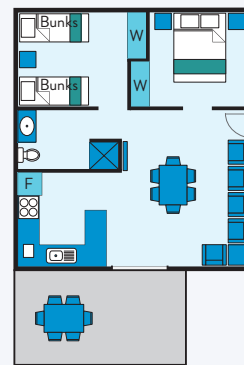

Lakeview Family Cottages

Rate: 2 persons
From \$195
Extra Guest (Aged 2 & over)
- \$25 each

Lakeview Family Cottages

Minimum 2 night stay

- Sleeps 8
- 3 bedrooms
- Self-contained
- 2 Queen beds & 2 sets of bunk beds
- 2 Bathrooms with shower, vanity, hair dryer
- Separate living area with dining table, chairs and lounges
- Full kitchen facilities – dishwasher, oven, cooktop, microwave, kettle, fridge, crockery, cutlery, glasses, sink
- Reverse cycle air conditioning
- All linen provided
- Electric blankets (excluding bunks)
- Flat screen TV
- Iron and Ironing Board
- Welcome tea, coffee, sugar, milk, shampoo & soap
- Outdoor setting
- Serviced daily
- Car park

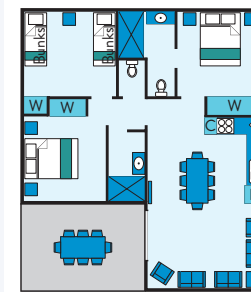

Lakeview Family Cottages

Rate: 2 persons
From \$225
Extra Guest (Aged 2 & over)
- \$25 each

Resort House

Minimum 2 night stay

- Sleeps 8
- 3 bedrooms
- Self-contained
- 2 Queen & 2 sets of bunk beds
- Bathroom with bath, shower, vanity, hair dryer
- Separate toilet
- Separate living area with dining table, chairs & 2 lounges
- Full kitchen facilities – dishwasher, oven, cooktop, microwave, toaster, kettle, large fridge, crockery, cutlery, glasses, sink
- Reverse cycle air conditioning
- All linen provided
- Electric blankets (excluding bunks)
- Flat screen TV
- Free Wi-Fi
- Iron & ironing board
- Welcome tea, coffee, sugar, milk, shampoo & soap
- Outdoor setting
- Serviced daily
- Car park

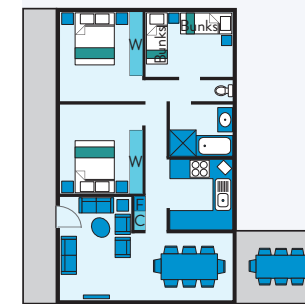

Resort House

Rate: 2 persons
From \$225
Extra Guest (Aged 2 & over)
- \$25 each

Lakeview House

Minimum 2 night stay

- Sleeps 10
- 3 bedrooms
- Self-contained
- 3 bedrooms
- 3 Queen & 2 sets of bunk beds
- 2 Bathrooms (no bath) with shower, vanity, hair dryer
- Separate living area with dining table, chairs & 2 lounges
- Full kitchen facilities – dishwasher, oven, cooktop, microwave, toaster, kettle, large fridge, crockery, cutlery, glasses, sink
- Reverse cycle air conditioning
- All linen provided
- Electric blankets (excluding bunks)
- Flat screen TV
- Free Wi-Fi
- Iron & ironing board
- Welcome tea, coffee, sugar, milk, shampoo & soap
- Outdoor setting
- Serviced daily
- Car park

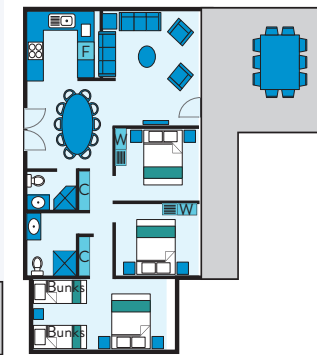

Lakeview House

Rate: 2 persons
From \$225
Extra Guest (Aged 2 & over)
- \$25 each