

## Cottages

- Sleeps 2
- Open Plan
- 1 Queen bed
- Ensuite bathroom with vanity, shower, toilet, hair dryer
- Microwave, toaster, kettle, bar fridge, crockery, cutlery, glasses, sink
- Reverse cycle air conditioning
- All linen provided
- Electric blankets
- Dining table & chairs
- Flat screen TV
- Free Wi-Fi
- Iron & ironing board
- Welcome tea, coffee, sugar, milk, shampoo & soap
- Outdoor setting
- Serviced daily
- Car park

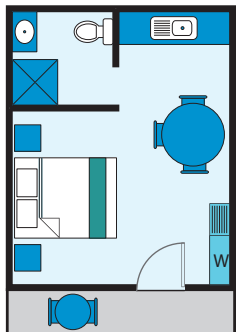

Cottages  
Rate: 2 persons  
From \$140

## Cottages

- Sleeps 3
- Open Plan
- 1 Queen bed & 1 single bed
- Ensuite bathroom with vanity, shower, toilet, hair dryer
- Microwave, toaster, kettle, bar fridge, crockery, cutlery, glasses, sink
- Reverse cycle air conditioning
- All linen provided
- Electric blankets
- Dining table & chairs
- Flat screen TV
- Free Wi-Fi
- Iron & ironing board
- Welcome tea, coffee, sugar, milk, shampoo & soap
- Outdoor setting
- Serviced daily
- Car park

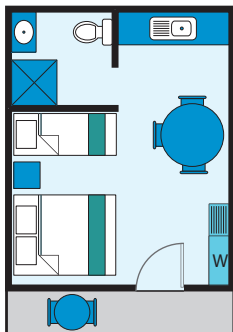

Cottages  
Rate: 2 persons  
From \$140  
Extra Guest (Aged 2 & over)  
- \$25 each

## Resort Rooms

- Sleeps 2 adults (no children allowed)
- Open Plan
- 1 Queen bed
- Ensuite bathroom with vanity, shower, toilet, hair dryer
- Kettle, bar fridge, mugs, glasses
- Reverse cycle air conditioning
- All linen provided
- Electric blankets
- Flat screen TV
- Free Wi-Fi
- Iron & ironing board
- Welcome tea, coffee, sugar, milk, shampoo & soap
- Serviced daily
- Car park

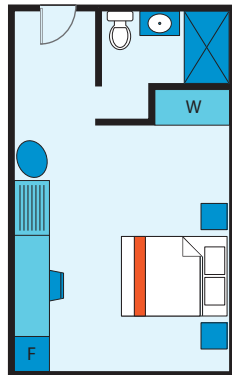

Resort Rooms  
Rate: 2 persons  
From \$165

## Resort Rooms

- Sleeps 2 adults (no children allowed)
- Open Plan
- 2 Queen beds
- Ensuite bathroom with vanity, shower, toilet, hair dryer
- Kettle, bar fridge, mugs, glasses
- Reverse cycle air conditioning
- All linen provided
- Electric blankets
- Flat screen TV
- Free Wi-Fi
- Iron & ironing board
- Welcome tea, coffee, sugar, milk, shampoo & soap
- Serviced daily
- Car park

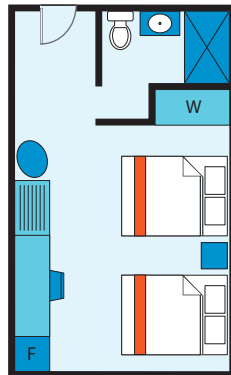

Resort Rooms  
Rate: 2 persons  
From \$165  
Extra Adult - \$25 each

## Lake-View Units

- Sleeps 2
- 1 bedroom
- 1 Queen bed
- Ensuite bathroom with toilet, shower, vanity, hair dryer (no bath)
- Separate living area with dining table, chairs & couch
- Microwave, toaster, kettle, bar fridge, crockery, cutlery, glasses, sink
- Reverse cycle air conditioning
- All linen provided
- Electric blankets
- Flat screen TV
- Free Wi-Fi
- Iron & ironing board
- Welcome tea, coffee, sugar, milk, shampoo & soap
- Outdoor setting
- Serviced daily
- Car park

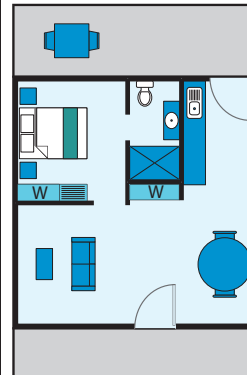

Lake-View Units  
Rate: 2 persons  
From \$165

## 2 Bedroom Units

- Sleeps 4
- 2 bedrooms
- 1 Queen bed & 2 singles beds
- Bathroom with vanity, shower, toilet, hair dryer
- Separate living area with dining table, chairs & couch
- Microwave, toaster, kettle, bar fridge, crockery, cutlery, glasses, sink
- Reverse cycle air conditioning
- All linen provided
- Electric blankets
- Flat screen TV
- Free Wi-Fi
- Iron & ironing board
- Welcome tea, coffee, sugar, milk, shampoo & soap
- Outdoor setting
- Serviced daily
- Car park

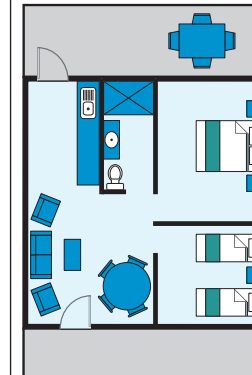

Two Bedroom Units  
Rate: 2 persons  
From \$165  
Extra Guest (Aged 2 & over)  
- \$25 each

## 2 Bedroom Units

- Sleeps 4
- 2 bedrooms
- 2 Queen beds
- Bathroom with vanity, shower, toilet, hair dryer
- Separate living area with dining table, chairs & couch
- Microwave, toaster, kettle, bar fridge, crockery, cutlery, glasses, sink
- Reverse cycle air conditioning
- All linen provided
- Electric blankets
- Flat screen TV
- Free Wi-Fi
- Iron & ironing board
- Welcome tea, coffee, sugar, milk, shampoo & soap
- Outdoor setting
- Serviced daily
- Car park

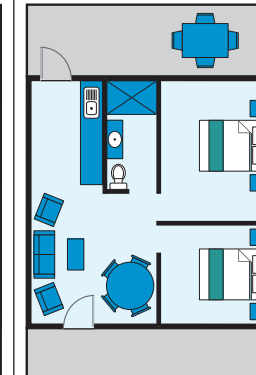

Two Bedroom Units  
Rate: 2 persons  
From \$165  
Extra Guest (Aged 2 & over)  
- \$25 each

## 2 Bedroom Spa Units

- Sleeps 4 adults (no children allowed)
- 2 bedrooms
- 2 Queen beds
- Two way bathroom with shower & separate spa, toilet, vanity, hair dryer
- Dining table and chairs & couch in living area
- Microwave, toaster, kettle, bar fridge, crockery, cutlery, glasses, sink
- Reverse cycle air conditioning
- All linen provided
- Electric blankets
- Flat screen TV
- Free Wi-Fi
- Iron & ironing board
- Welcome tea, coffee, sugar, milk, shampoo & soap
- Outdoor setting
- Serviced daily
- Car park

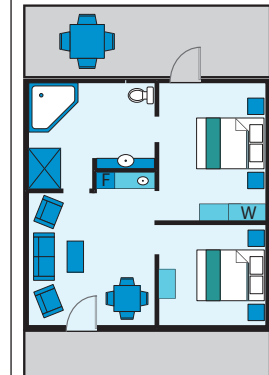

2 Bedroom Spa Units  
Rate: 2 persons  
From \$190  
Extra Adult - \$25 each

**Limited Mobility Unit**

- Sleeps 2
- 1 bedroom
- Self-Contained
- 1 Queen bed
- Ensuite bathroom with vanity, shower, toilet, hair dryer
- Cook-top, oven, dishwasher, microwave, toaster, kettle, bar fridge, crockery, cutlery, glasses, sink
- Reverse cycle air conditioning
- All linen provided
- Electric blankets
- Dining table and chairs
- Flat screen TV
- Free Wi-Fi
- Iron & ironing board
- Welcome tea, coffee, sugar, milk, shampoo and soap
- Outdoor setting
- Serviced daily
- Car park

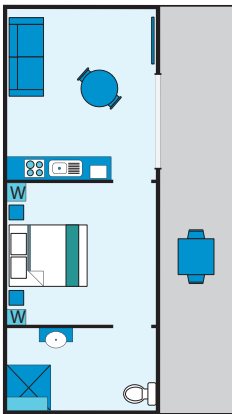

Limited Mobility Unit

Rate: 2 persons  
From \$175

**Limited Mobility Unit**

- Sleeps 4
- 2 bedroom
- Self-Contained
- 2 Queen beds
- Ensuite bathroom with vanity, shower, toilet, hair dryer
- Cook-top, oven, dishwasher, microwave, toaster, kettle, bar fridge, crockery, cutlery, glasses, sink
- Reverse cycle air conditioning
- All linen provided
- Electric blankets
- Dining table & chairs
- Flat screen TV
- Free Wi-Fi
- Iron & ironing board
- Welcome tea, coffee, sugar, milk, shampoo & soap
- Outdoor setting
- Serviced daily
- Car park

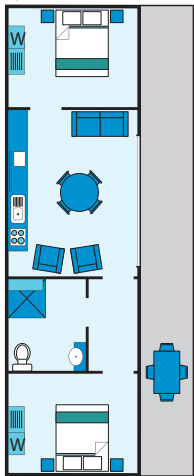

Limited Mobility Unit

Rate: 2 persons  
From \$175  
Extra Guest (Aged 2 & over)  
- \$25 each

**Family Cottage**

- Sleeps 6
- 2 bedroom
- 1 Queen bed, 2 singles & 1 set of bunk beds
- Ensuite bathroom with vanity, shower, toilet, hair dryer
- Cook top, microwave, toaster, kettle, large fridge, crockery, cutlery, glasses, sink
- Reverse cycle air conditioning
- All linen provided
- Electric blankets (excluding bunks)
- Flat screen TV
- Free Wi-Fi
- Iron & ironing board
- Welcome tea, coffee, sugar, milk, shampoo & soap
- Outdoor setting
- Serviced daily
- Car park

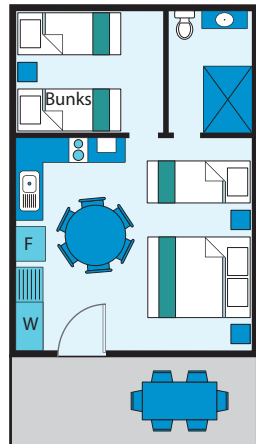

Family Cottage

Rate: 2 persons  
From \$165  
Extra Guest (Aged 2 & over)  
- \$25 each

**Lake View Family Cottages**

**Minimum 2 night stay**

- Sleeps 6
- 2 bedrooms
- Self-Contained
- 1 Queen bed & 2 Sets of bunk beds
- 1 Bathroom with shower, vanity, hair dryer
- Separate living area with dining table, chairs and lounges
- Full Kitchen facilities – dishwasher, oven, cooktop, microwave, Kettle, fridge, crockery, cutlery, glasses, sink
- Reverse cycle air conditioning
- All linen provided
- Electric blankets (excluding bunks)
- Flat screen TV
- Iron and Ironing Board
- Welcome tea, coffee, sugar, milk, shampoo & soap
- Outdoor setting
- Serviced daily
- Car park

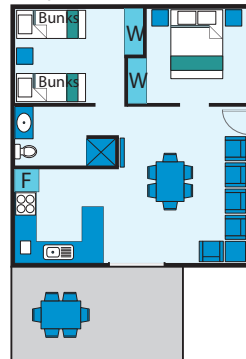

Lake View Family Cottages

Rate: 2 persons  
From \$195  
Extra Guest (Aged 2 & over)  
- \$25 each

**Lake View Family Cottages**

**Minimum 2 night stay**

- Sleeps 8
- 3 bedrooms
- Self-Contained
- 2 Queen beds & 2 Sets of bunk beds
- 2 Bathrooms with shower, vanity, hair dryer
- Separate living area with dining table, chairs and lounges
- Full Kitchen facilities – dishwasher, oven, cooktop, microwave, Kettle, fridge, crockery, cutlery, glasses, sink
- Reverse cycle air conditioning
- All linen provided
- Electric blankets (excluding bunks)
- Flat screen TV
- Iron and Ironing Board
- Welcome tea, coffee, sugar, milk, shampoo & soap
- Outdoor setting
- Serviced daily
- Car park

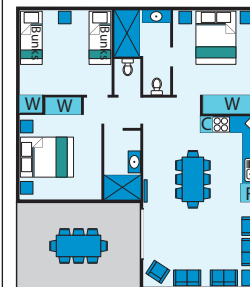

Lake View Family Cottages

Rate: 2 persons  
From \$195  
Extra Guest (Aged 2 & over)  
- \$25 each

**Resort House**

**Minimum 2 night stay**

- Sleeps 8
- 3 bedrooms
- Self-Contained
- 2 Queen & 2 sets of bunk beds
- Bathroom with bath, shower, vanity, hair dryer
- Separate toilet
- Separate living area with dining table, chairs & 2 lounges
- Full kitchen facilities – dishwasher, oven, cook top, microwave, toaster, kettle, large fridge, crockery, cutlery, glasses, sink
- Reverse cycle air conditioning
- All linen provided
- Electric blankets (excluding bunks)
- Flat screen TV
- Free Wi-Fi
- Iron & ironing board
- Welcome tea, coffee, sugar, milk, shampoo & soap
- Outdoor setting
- Serviced daily
- Car park

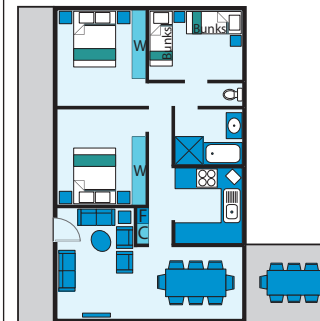

Resort House

Rate: 2 persons  
From \$225  
Extra Guest (Aged 2 & over)  
- \$25 each

**Lake View House**  
**Minimum 2 night stay**

- Sleeps 10
- 3 bedrooms
- Self-Contained
- 3 bedrooms
- 3 Queen & 2 sets of bunk beds
- 2 Bathrooms (no bath with shower, vanity, hair dryer)
- Separate living area with dining table, chairs & 2 lounges
- Full kitchen facilities – dishwasher, oven, cook top, microwave, toaster, kettle, large fridge, crockery, cutlery, glasses, sink
- Reverse cycle air conditioning
- All linen provided
- Electric blankets (excluding bunks)
- Flat screen TV
- Free Wi-Fi
- Iron & ironing board
- Welcome tea, coffee, sugar, milk, shampoo & soap
- Outdoor setting
- Serviced daily
- Car park



Lake View house

Rate: 2 persons  
From \$225  
Extra Guest (Aged 2 & over)  
- \$25 each